

PLATE 56

PLATE 55

PHILADELPHIA BRIDGE
GLOUCESTER TO

50' ELLIS STREET 50'

12.01	82.4	12.02	20'	20'
11.01	81.5	11.02	20'	20'
10.01	80	10.02	20'	20'
9	77	117	20'	20'
8	116	115	20'	20'

60' KING STREET

6	80'	20'	20'	20'	20'	20'	20'	
5	80'	20'	20'	7	8	9	10	11
4	80'	20'	20'	20'	20'	20'	20'	20'
3	80'	20'	20'	100'	100'	100'	100'	100'
2	80'	11.75'	20'	20'	20'	20'	20'	20'
1	80'	13.25'	20'	20'	20'	20'	20'	20'

PLATE 2

20' WILLOW STREET 20'

12	90'	20'	20'	13	90'	20'	20'
11	90'	20'	20'	14	90'	20'	20'
10	90'	20'	20'	15	90'	20'	20'
9	90'	20'	20'	16	90'	20'	20'
8	90'	20'	20'	17	90'	20'	20'
7	90'	20'	20'	18	90'	20'	20'
6	90'	20'	20'	19	90'	20'	20'
5	90'	20'	20'	20	90'	20'	20'
4	90'	20'	20'	21	90'	20'	20'
3	90'	20'	20'	54.4'	110.5'	20'	20'
2	12.75'	14.4'	20'	20'	20'	20'	20'
1	83'	91.75'	20'	20'	20'	20'	20'

N. BURLINGTON STREET

PLATE 3

WARREN STREET

40' LINDEN STREET 40'

SHERMAN STREET

PLATE 19

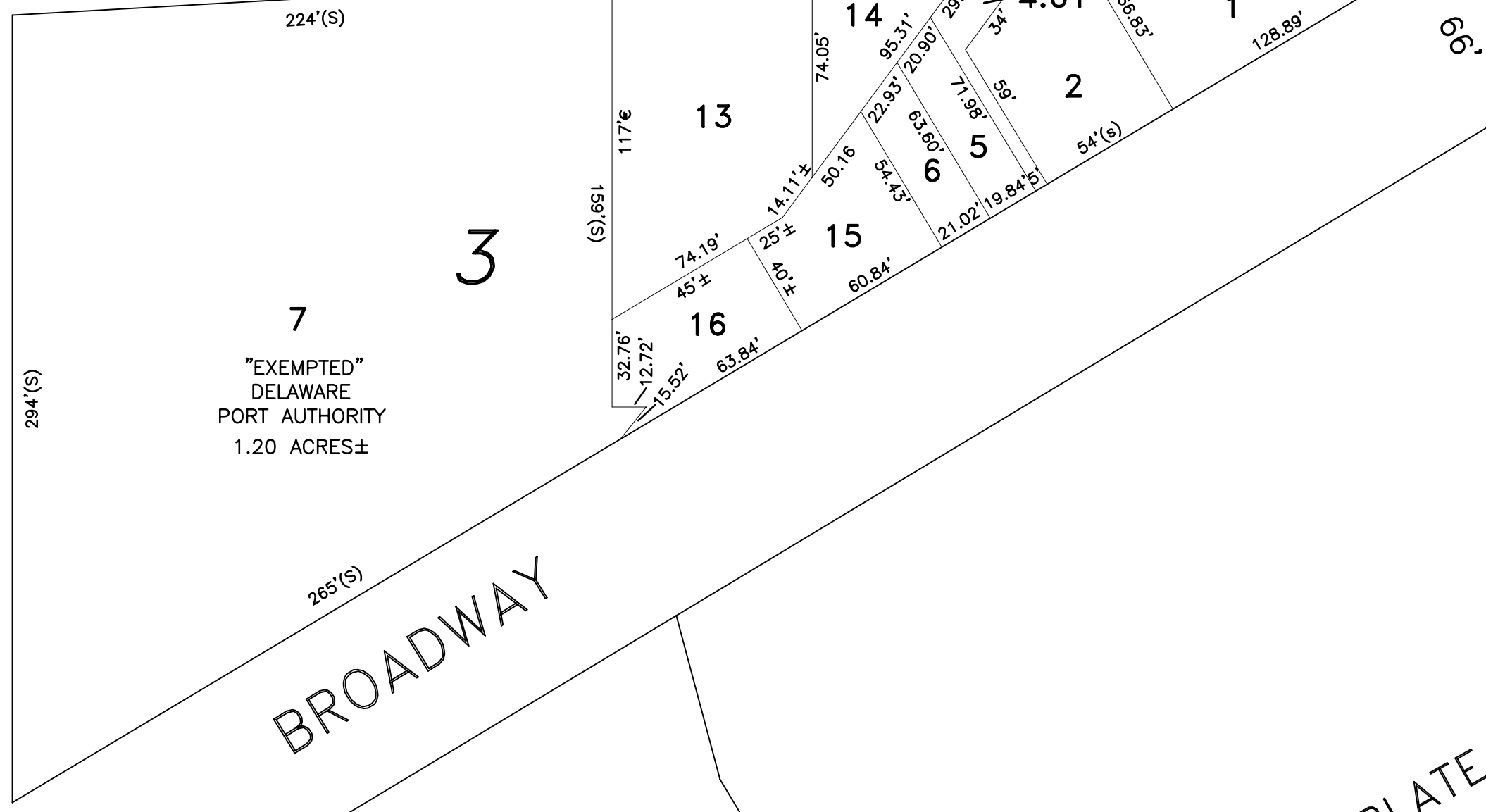

PLATE 54

"THIS TAX MAP PLATE HAS BEEN DIGITALLY DRAWN USING COMPUTER-AIDED DRAFTING/DESIGN (CADD) AND COORDINATE GEOMETRY (COGO). IT IS BASED ON THE ORIGINAL DIGITALLY DRAWN TAX MAP PLATE BEARING THE OFFICIAL NEW JERSEY DIVISION OF TAXATION APPROVAL STAMP WITH APPROVAL DATE 3-24-1994, SERIAL NUMBER 759 AND SIGNATURE OF SIGNER IVAN HAFKOWYCZ P.E., L.S. THIS TAX MAP PLATE HAS BEEN DIGITALLY UPDATED TO REFLECT CONDITIONS AS OF 11-18-2004. THE ORIGINAL DRAWN TAX MAP PLATE WITH THE OFFICIAL APPROVAL STAMP IS ON FILE WITH REMINGTON AND VERNICK ENGINEERS."

TAX MAP
CITY OF GLOUCESTER
 CAMDEN COUNTY NEW JERSEY
 SCALE: 1" = 50' DATE: 5-15-1992
CRAIG F. REMINGTON LAND SURVEYOR LIC. NO. 23924
 24 GA 28003800
REMINGTON & VERNICK ENGINEERS
 232 KING'S HIGHWAY EAST HADDONFIELD, N.J. 08033
 (856) 795-9595, FAX (856) 795-1882
 WEB SITE ADDRESS: WWW.RVVE.COM