

PLATE 58

DELAWARE RIVER

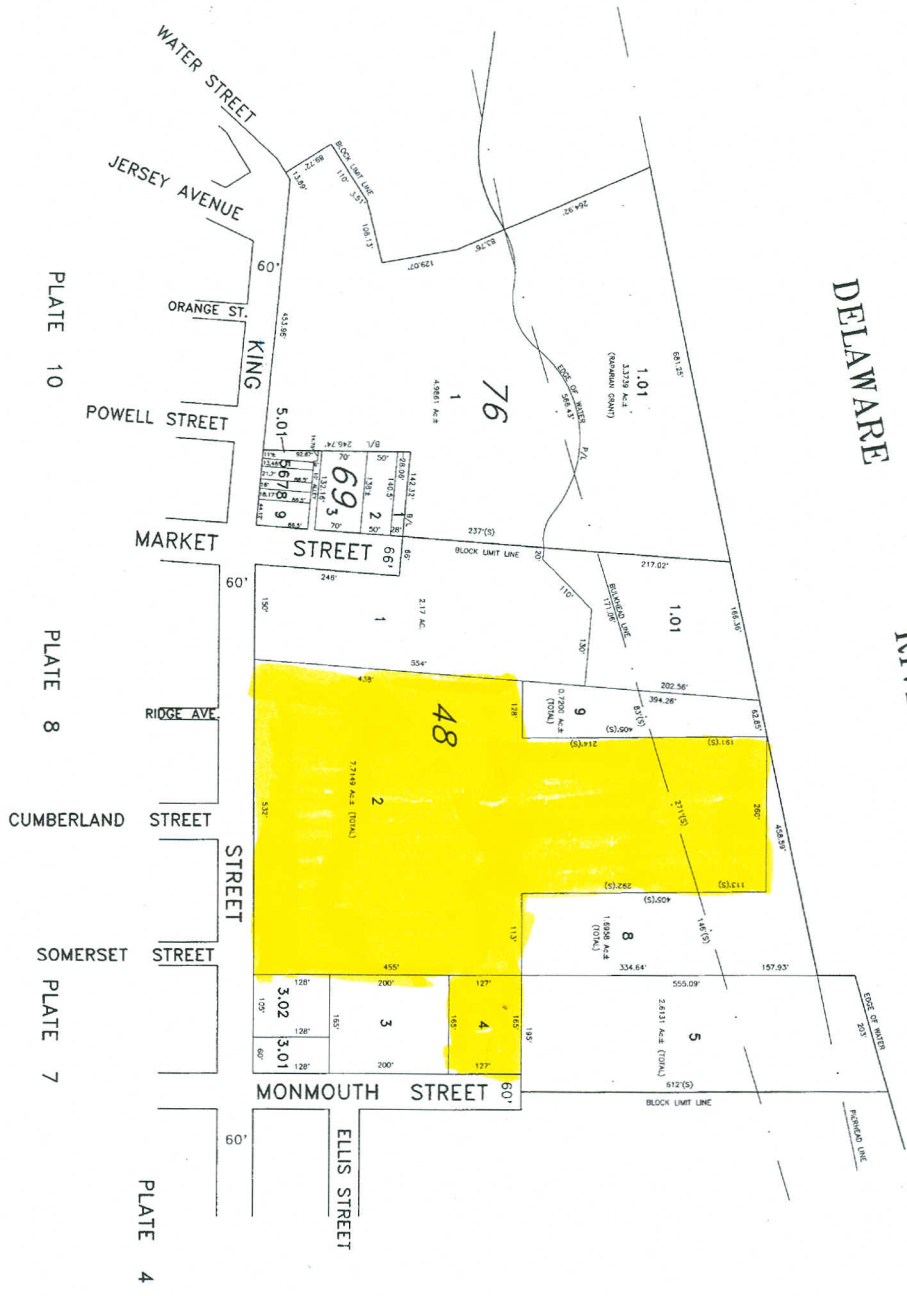

PLATE 56

2.37

NOT TO SCALE. DISTANCES OF THE PROPERTY  
 INDICATED ARE APPROXIMATE. FOR THE  
 PURPOSES OF THE TAX MAP, THE  
 DISTANCE OF THE PROPERTY IS  
 BASED ON THE DISTANCE OF THE  
 PROPERTY AS SHOWN ON THE  
 TAX MAP. THE DISTANCE OF THE  
 PROPERTY IS NOT GUARANTEED.  
 DATE: MAR 8, 1984. SCALE: 1" = 100'

**TAX MAP**  
**CITY OF GLOUCESTER**  
 CAMDEN COUNTY NEW JERSEY  
**CRAIG F. REMINGTON L.S.** 23924  
 REMINGTON AND VERNICK ENGINEERS  
 232 KINGS HIGHWAY EAST  
 HADDONFIELD, NEW JERSEY