

REVISIONS		
10-13-2011	CRAIG F. REMINGTON	23924
12-31-2011	CRAIG F. REMINGTON	23924
01-02-2013	CRAIG F. REMINGTON	23924

NOTE:
THIS SHEET HAS BEEN DRAWN USING COMPUTER AIDED DRAFTING/DESIGN (CAD/D) AND COORDINATE GEOMETRY (COGO).

NOTE:
FOLLOWING PROPERTIES ARE "EXEMPT" - CITY OF GLOUCESTER
BLOCK 59.01, LOT 17
BLOCK 59.01, LOT 20
BLOCK 59.01, LOT 21
BLOCK 59.01, LOT 22

SHEET 7

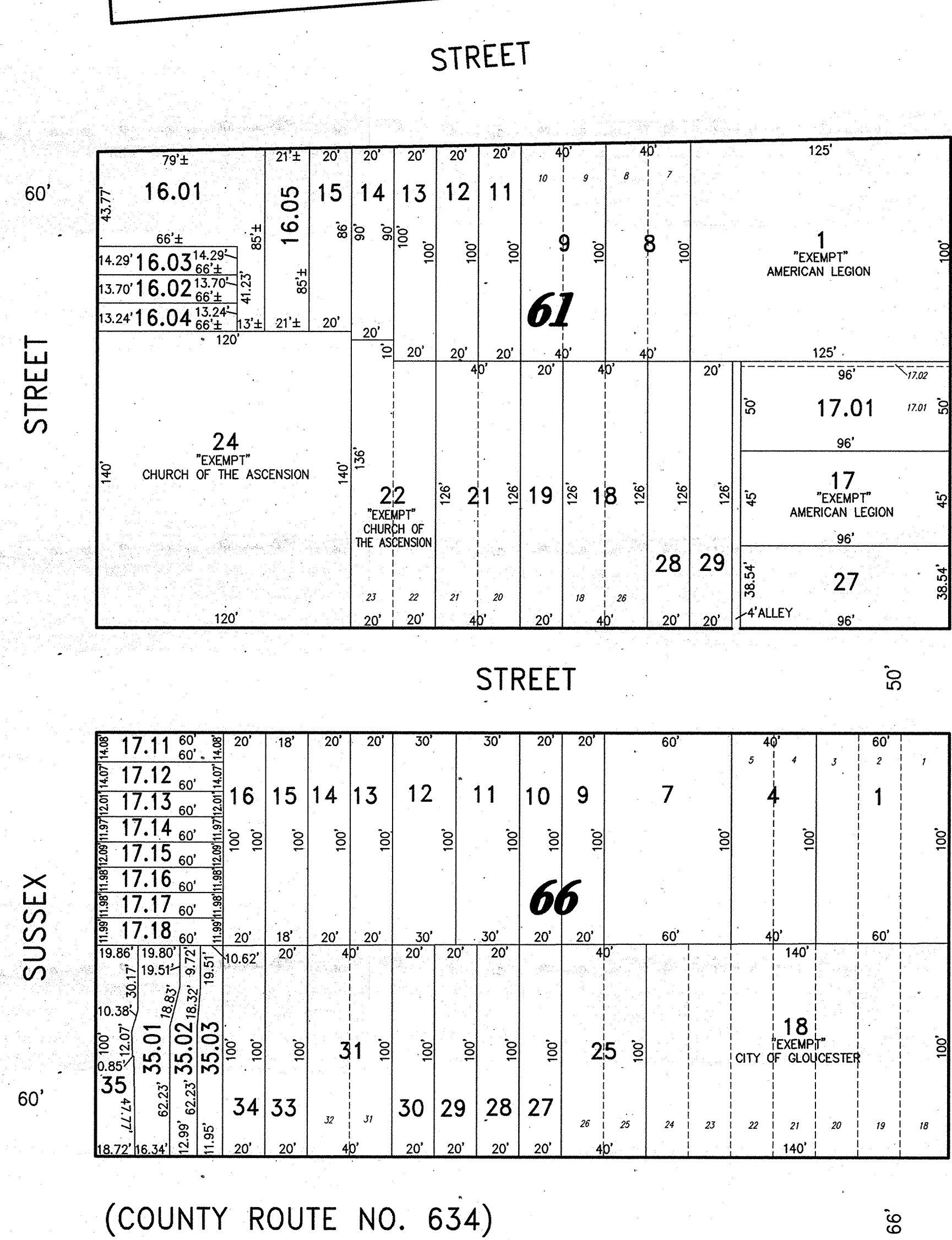
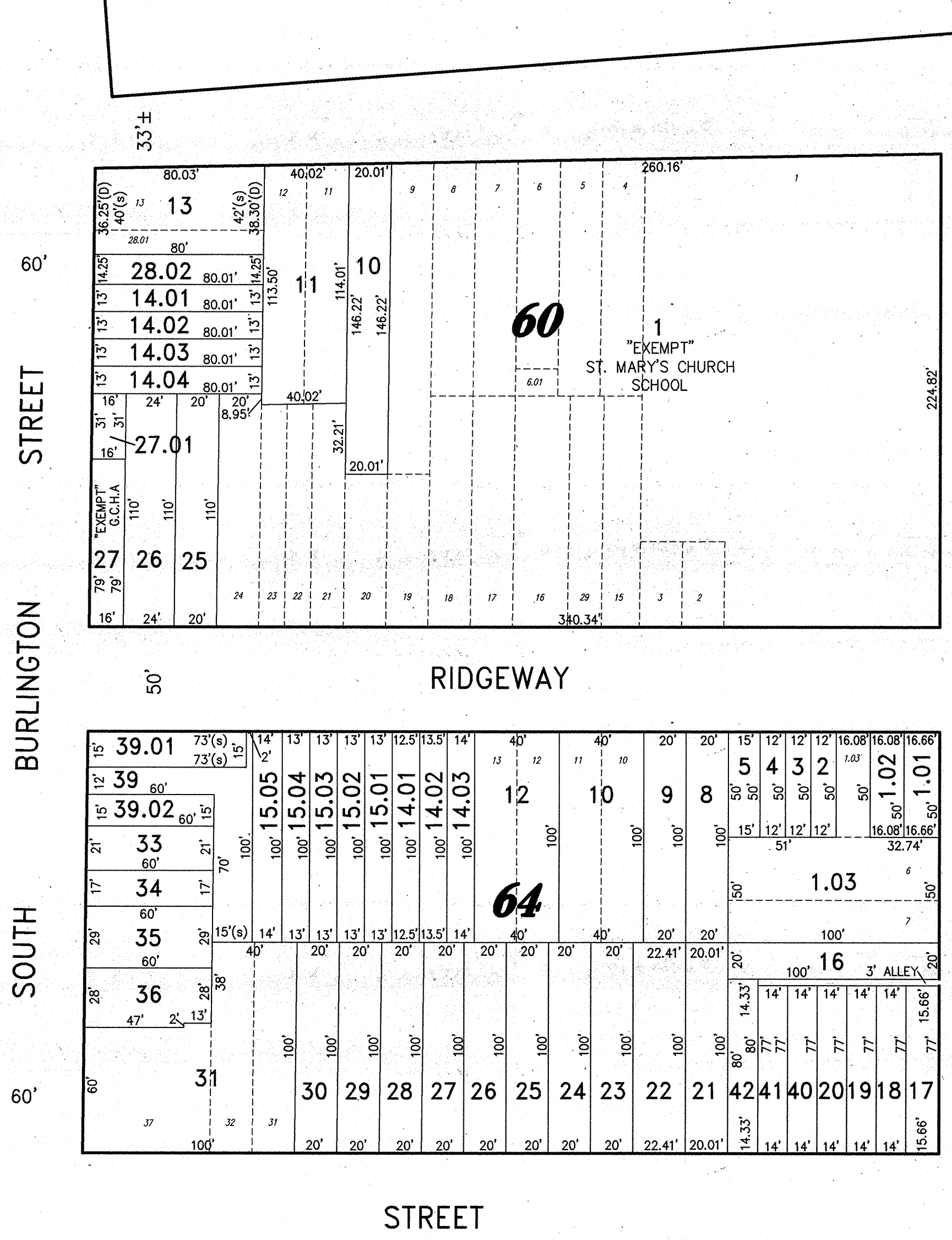
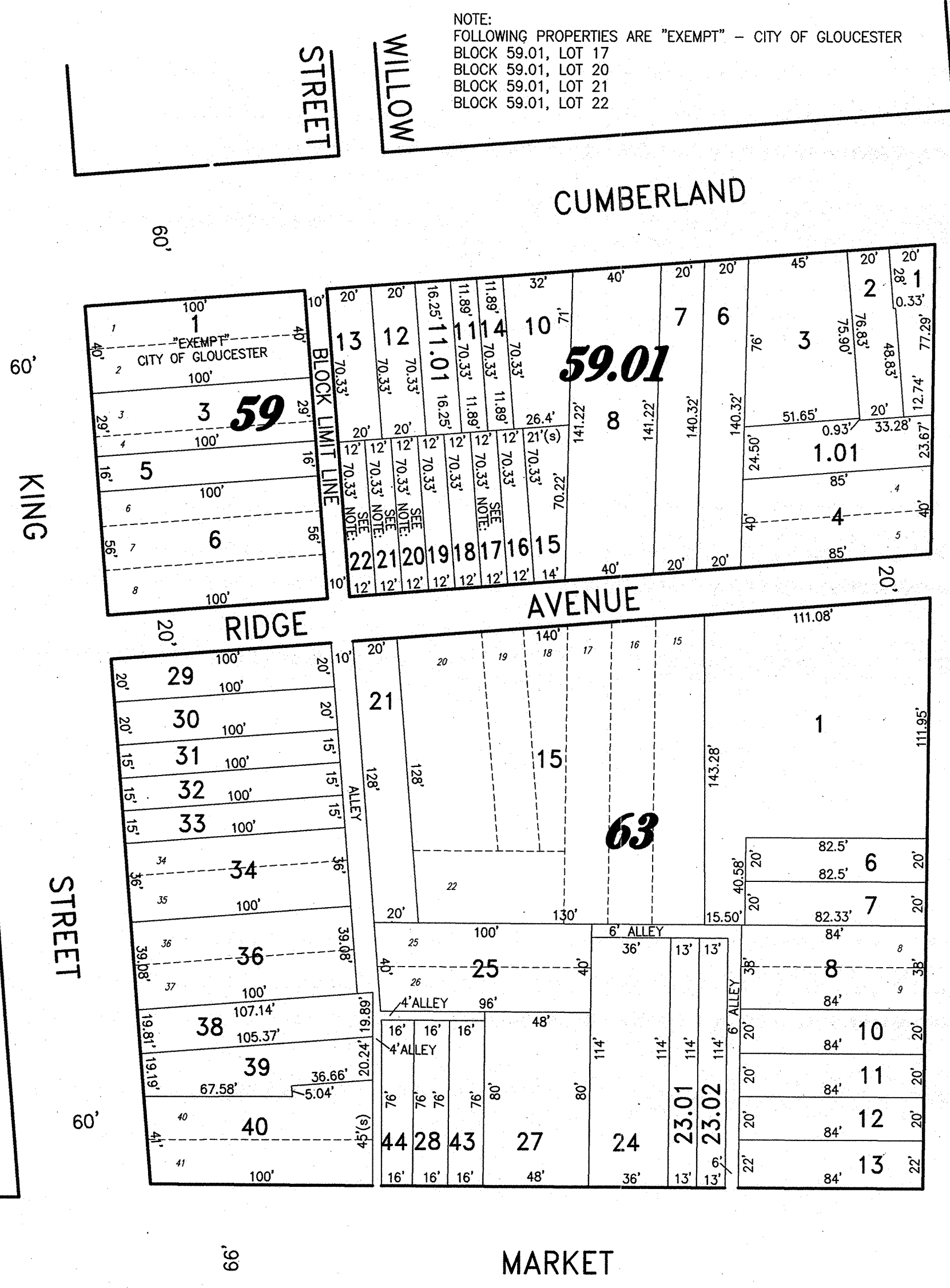

SHEET 57

SHEET 9

SHEET 10

SHEET 11

NEW JERSEY DEPARTMENT OF THE TREASURY
DIVISION OF TAXATION
PROPERTY ADMINISTRATION TAX MAP SECTION
APPROVED AS A TAX MAP PURSUANT TO THE
AUTHORITY OF N.J.S.A. 54-1-15 & N.J.S.A. 54-50-1
FOR THE DIRECTOR, DIVISION OF TAXATION

Sue Davison CTA Supervising Field Rep
Sue Davison, CTA Supervising Field Rep

DATE **DEC 11 2013** SERIAL NO. **1030**

TAX MAP
CITY OF GLOUCESTER
CAMDEN COUNTY NEW JERSEY
SCALE: 1" = 50' DATE: 5-15-1992

CRAIG F. REMINGTON LAND SURVEYOR LIC. NO. 23924

REMINGTON & VERNICK ENGINEERS
232 KING'S HIGHWAY EAST HADDONFIELD, N.J. 08033
(856) 795-9595, FAX (856) 795-6892
WEB SITE ADDRESS: WWW.RVE.COM

TO SHOW CONDITIONS AS OF 06-18-2013