

REVISIONS		
11-18-2004	CRAIG F. REMINGTON	23924
12-31-2011	CRAIG F. REMINGTON	23924
01-02-2013	CRAIG F. REMINGTON	23924

NOTE:
THIS SHEET HAS BEEN DRAWN USING COMPUTER AIDED DRAFTING/DESIGN (CAD/D) AND COORDINATE GEOMETRY (COGO).

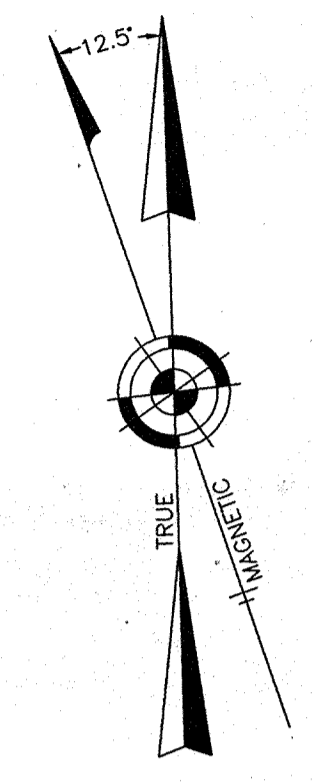

ESSEX ST.
MORRIS ST.
MERCER ST.
PLUM ST.
MIDDLESEX ST.

SHEET 3

SHEET 6

(COUNTY ROUTE NO. 551)

BROADWAY

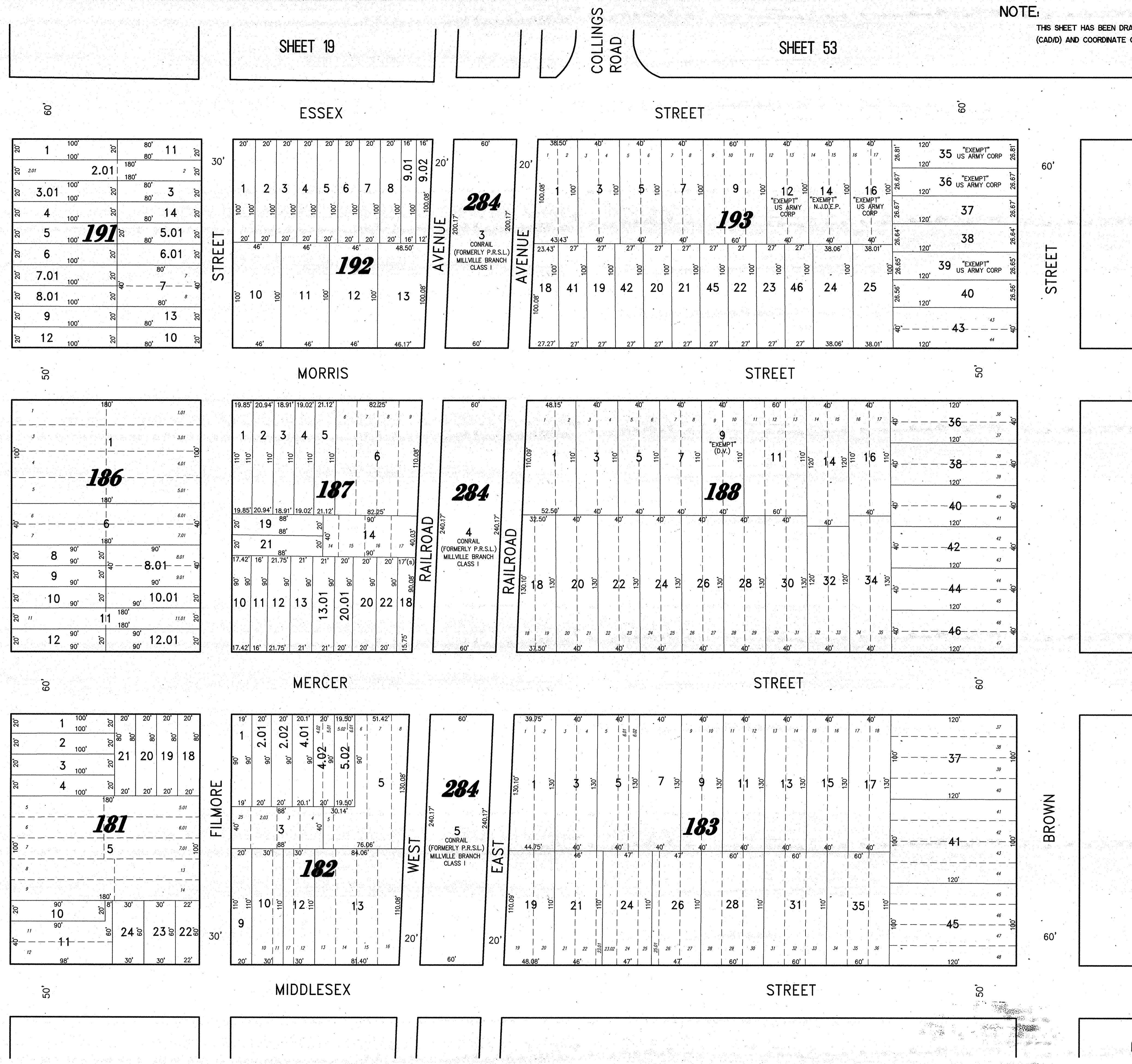

SHEET 22

SHEET 21

NEW JERSEY DEPARTMENT OF THE TREASURY
DIVISION OF TAXATION
PROPERTY ADMINISTRATION TAX MAP SECTION
APPROVED AS A TAX MAP PURSUANT TO THE
AUTHORITY OF N.J.S.A. 54:1-15 & N.J.S.A. 54:1-16
FOR THE DIRECTOR, DIVISION OF TAXATION:

Sue Davison, CTA Supervising Field Rep
Sue Davison, CTA Supervising Field Rep

DATE: DEC 11 2013 SERIAL NO. 1030

TAX MAP
CITY OF GLOUCESTER

CAMDEN COUNTY NEW JERSEY
SCALE: 1" = 50' DATE: 5-15-1992

CRAIG F. REMINGTON LAND SURVEYOR LIC. NO. 23924



REMINGTON & VERNICK ENGINEERS
232 KING'S HIGHWAY EAST HADDONFIELD, NJ 08033
(856) 795-9595, FAX (856) 795-1982
WEB SITE ADDRESS: WWW.RVE.COM

TO SHOW CONDITIONS AS OF 06-18-2013