

REVISIONS		
11-18-2004	CRAIG F. REMINGTON	23924
12-31-2011	CRAIG F. REMINGTON	23924
01-02-2013	CRAIG F. REMINGTON	23924

**NOTE:**  
THIS SHEET HAS BEEN DRAWN USING COMPUTER AIDED DRAFTING/DESIGN (CAD/D) AND COORDINATE GEOMETRY (COGO).

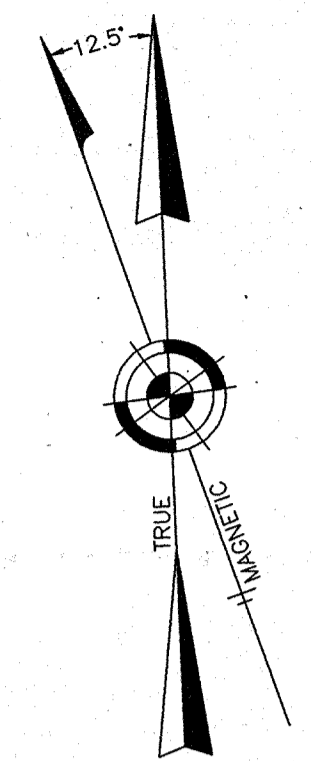

SHEET 51

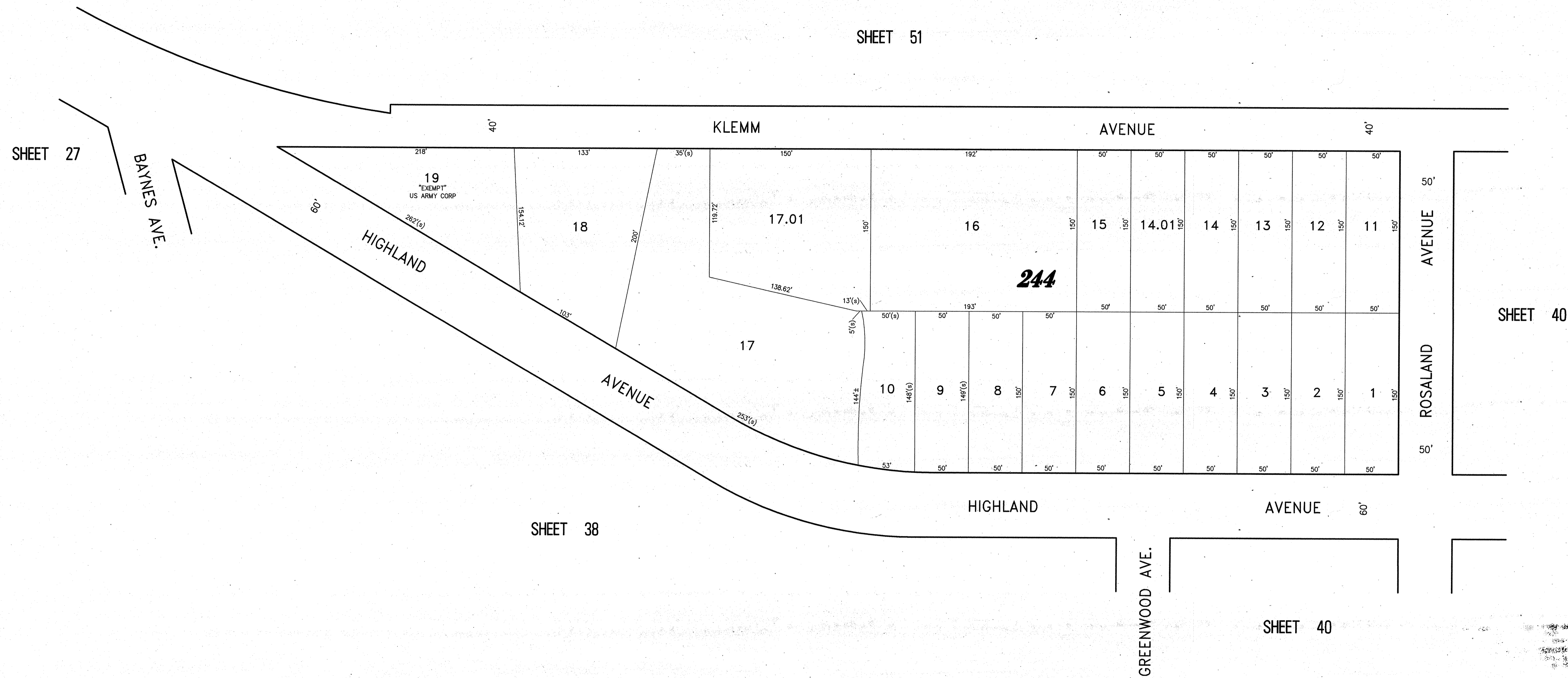

SHEET 27

BAYNES AVE.

SHEET 40

SHEET 38

SHEET 40

GREENWOOD AVE.

**TAX MAP**  
**CITY OF GLOUCESTER**

CAMDEN COUNTY - NEW JERSEY  
SCALE: 1" = 50' DATE: 5-15-1992

CRAIG F. REMINGTON LAND SURVEYOR LIC. NO. 23924

NEW JERSEY DEPARTMENT OF TREASURY  
DIVISION OF TAXATION  
PROPERTY ADMINISTRATION TAX MAP SECTION  
APPROVED AS A TAX MAP PURSUANT TO THE  
AUTHORITY OF N.J.S.A.C:17-28 & N.J.S.A. 54:28-4  
PL: THE DIRECTOR, DIVISION OF TAXATION

*[Signature]* CTA Supervising Field Rep  
*[Signature]* CTA Supervising Field Rep

DATE: 1030 ORIGINAL DATE: DEC 11 2013

**REMINGTON & VERNICK ENGINEERS**  
232 KING'S HIGHWAY EAST HADDONFIELD, NJ 08033  
(856) 795-9595, FAX (856) 795-1882  
WEB SITE ADDRESS: WWW.RVE.COM

TO SHOW CONDITIONS AS OF 06-18-2013