

| REVISIONS | | |
|------------|--------------------|-------|
| 11-18-2004 | CRAIG F. REMINGTON | 23924 |
| 12-31-2011 | CRAIG F. REMINGTON | 23924 |
| 01-02-2013 | CRAIG F. REMINGTON | 23924 |
| | | |
| | | |
| | | |
| | | |
| | | |
| | | |
| | | |
| | | |

NOTE:
THIS SHEET HAS BEEN DRAWN USING COMPUTER AIDED DRAFTING/DESIGN (CAD/D) AND COORDINATE GEOMETRY (COGO).

SHEET 51

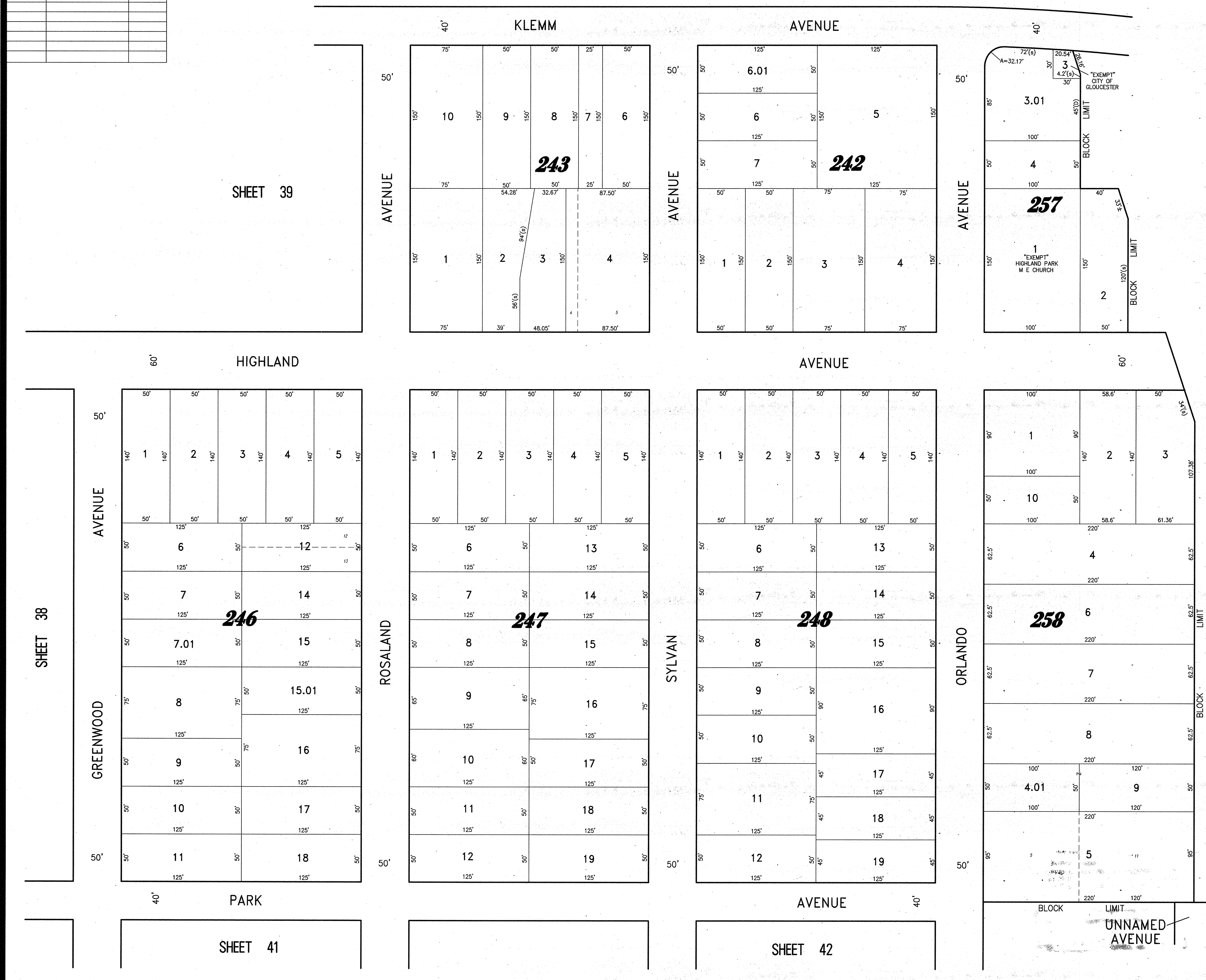
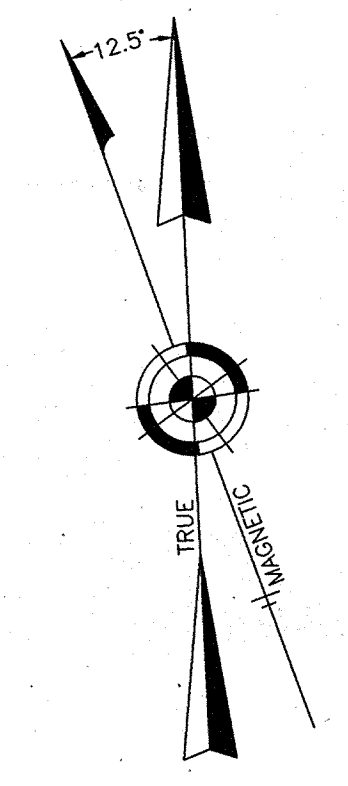

SHEET 39

SHEET 38

SHEET 43

SHEET 41

SHEET 42

NEW JERSEY DEPARTMENT OF TREASURY
PROPERTY APPRAISAL DIVISION
APPROVED FOR THE SUPERVISOR OF THE
ANNUAL CITY OF GLOUCESTER TAX MAP
BY THE DIRECTOR, DIVISION OF TAXATION
[Signature]
DATE: **DEC 11 2013** MAP NO. **1030**

TAX MAP
CITY OF GLOUCESTER
CAMDEN COUNTY NEW JERSEY
SCALE: 1" = 50' DATE: 5-15-1992

CRAIG F. REMINGTON LAND SURVEYOR LIC. NO. 23924

REMINGTON & VERNICK ENGINEERS
232 KING'S HIGHWAY EAST HADDONFIELD, N.J. 08033
(856) 795-9595, FAX (856) 795-1882
WEB SITE ADDRESS: WWW.RVE.COM
TO SHOW CONDITIONS AS OF 06-18-2013