

# KEY MAP

NOTES: 1. THE AREAS, BOUNDARIES AND DIMENSIONS, SHOWN ON THIS TAX MAP, ARE DERIVED FROM GROUND SURVEYS, AERIAL SURVEYS, AND RECORDED PLANS, MAPS, DEEDS AND WILLS, ARE TO BE USED FOR ASSESSMENT PURPOSES ONLY;  
 2. THIS TAX MAP SUPERSEDES THE TAX MAP APPROVED DATE: 3-24-1994  
 3. THESE MAPS HAVE BEEN DRAWN USING COMPUTER AIDED DRAFTING/DESIGN (CAD/D) AND COORDINATE GEOMETRY (COGO).  
 4. AREA OF MUNICIPALITY, 183.0 ACRES +/-

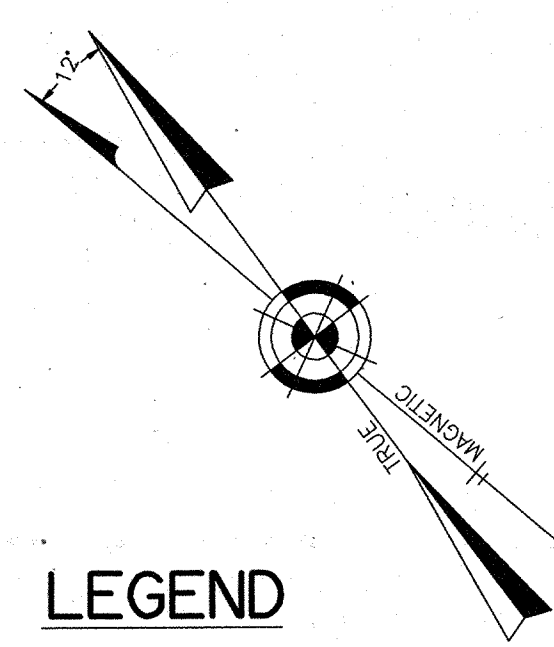

## LEGEND

### KEY MAP

- 10 PLATE NUMBER
- 107 BLOCK NUMBER
- ARTIFICIAL-BLOCK-LIMIT-LINE
- PLATE DELINEATION LINE
- MUNICIPAL BOUNDARY LINE
- COUNTY BOUNDARY LINE
- STATE BOUNDARY LINE
- WATERWAY LINES
- PIERHEAD LINE
- BULKHEAD LINE
- PIERHEAD OR BULKHEAD LINE
- PIERHEAD OR BULKHEAD LINE (BLOCK LIMIT LINE)

## BOROUGH OF MT. EPHRAIM

### COUNTY OF CAMDEN

## DETAIL SHEET

- 1.01 NEW BLOCK NUMBERS
- 5 NEW LOT NUMBERS
- (C-108) OLD BLOCK NUMBERS
- 4 OLD LOT NUMBERS
- ARTIFICIAL-BLOCK-LIMIT-LINE
- LOT LINE
- OLD LOT LINE (PROPERTY LINE)
- WATERWAY LINES
- ASSESSMENT LINE
- PIERHEAD LINE
- BULKHEAD LINE
- PIERHEAD OR BULKHEAD LINE
- PIERHEAD OR BULKHEAD LINE (BLOCK LIMIT LINE)

## KEY MAP

### CITY OF GLOUCESTER

CAMDEN COUNTY NEW JERSEY  
 SCALE: 1" = 400' DATE: 5-15-1992

CRAIG F. REMINGTON LAND SURVEYOR LIC. NO. 23924

REMINGTON & VERNICK ENGINEERS  
 24 GA 28003800  
 232 KING'S HIGHWAY EAST HADDONFIELD, N.J. 08033  
 (856) 795-9595, FAX (856) 795-1882  
 WEB SITE ADDRESS: WWW.RVCE.COM

TO SHOW CONDITIONS AS OF 06-18-2013

NEW JERSEY DEPARTMENT OF TREASURY  
 OFFICE OF THE CHIEF OF PROPERTY ASSESSMENT  
 APPROVED AS A TAX MAP PURSUANT TO THE  
 AUTHORITY OF PUBLIC LAW 93-502  
 JUDY MILLER, CTA, Chief Valuation Mapping  
 Date: DEC 11 2013

"I HEREBY CERTIFY THAT THIS MAP HAS BEEN REVISED UNDER MY IMMEDIATE SUPERVISION, AND COMPLIES WITH THE LAWS OF THE STATE OF NEW JERSEY."

Craig F. Remington  
 CRAIG F. REMINGTON NJ PROFESSIONAL LAND SURVEYOR LIC. NO. 23924

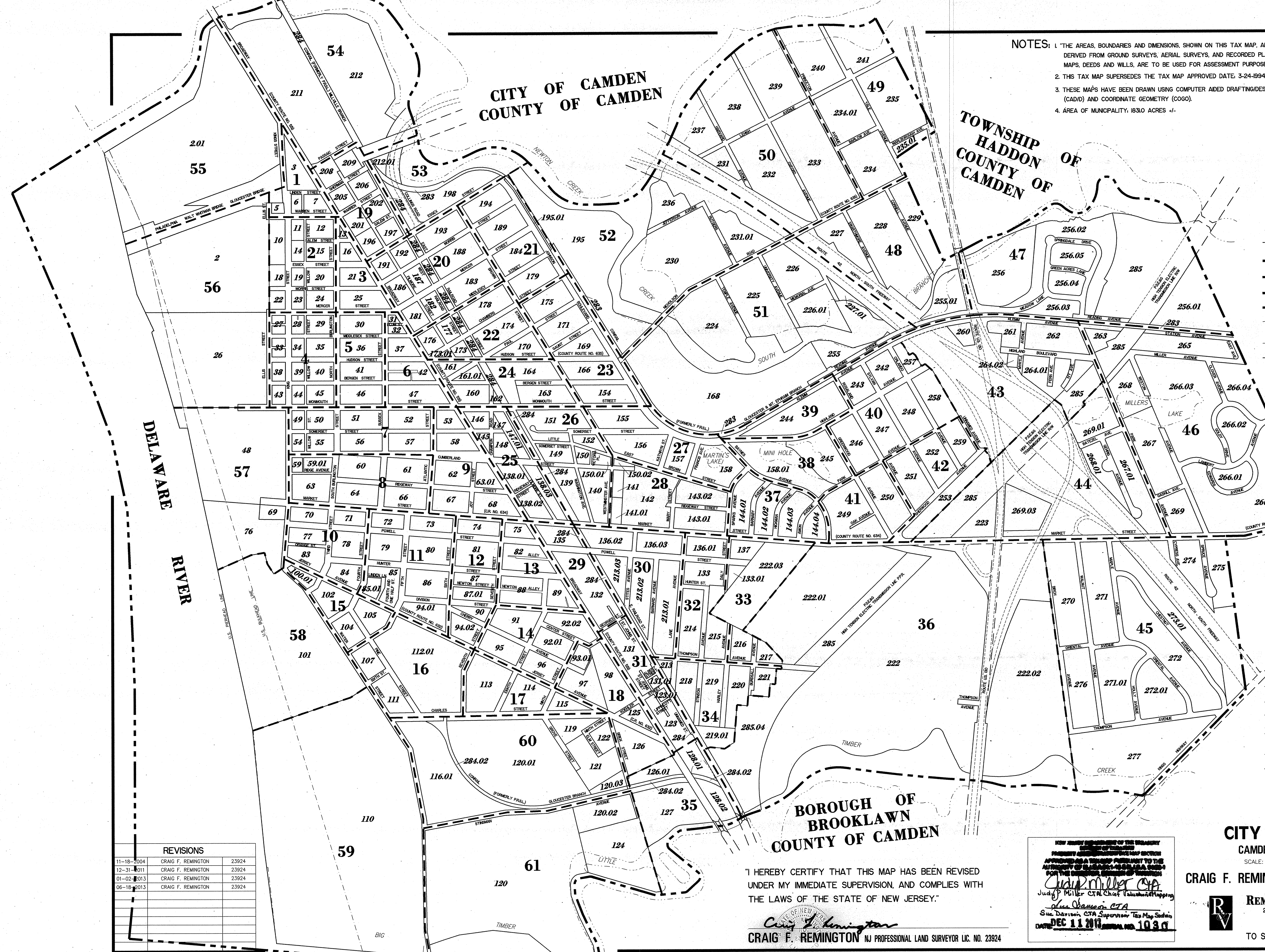

REVISIONS		
11-18-2004	CRAIG F. REMINGTON	23924
12-31-011	CRAIG F. REMINGTON	23924
01-02-2013	CRAIG F. REMINGTON	23924
06-18-2013	CRAIG F. REMINGTON	23924

## BOROUGH OF WESTVILLE

### COUNTY OF GLOUCESTER

# KEY MAP